

*Bakersfield*

**River Run**



**RV Park**

# Emergency Preparedness Plan

---

Developed as required by Senate Bill 23

**9/10/2010**

Revision 1 2/1/2011

Approved by HCD 5/4/2011

This is the Emergency Preparedness Plan for compliance with Senate Bill 23. If you have any questions or concerns please feel free to contact the park office.



## Emergency Preparedness Plan

### Contents

Emergency Evacuation Route and Park Elevation Map.....	3
Common Disasters & Procedures for Responding to Each.....	4
1.Earthquake.....	4
2.Fire .....	4
3.Flood .....	5
Provisions for residents who may need assistance .....	6
1.Introduction .....	7
2.Checklist of Emergency Procedures .....	7
3.If Disaster Strikes: .....	8
4.Remember to:.....	8
5.First Aid Procedures.....	9
6.Be Prepared! .....	9
7.Family Disaster Supplies Kit .....	9
8.Family Disaster Supplies Kit Checklist:.....	10
Local Emergency Phone Numbers .....	11
Local Emergency Broadcast Station Frequencies .....	11
FEMA Regulations.....	12
California Regulations.....	12



# Emergency Preparedness Plan

## Emergency Evacuation Route and Park Elevation Map

# Bakersfield River Run RV Park EVACUATION ROUTE

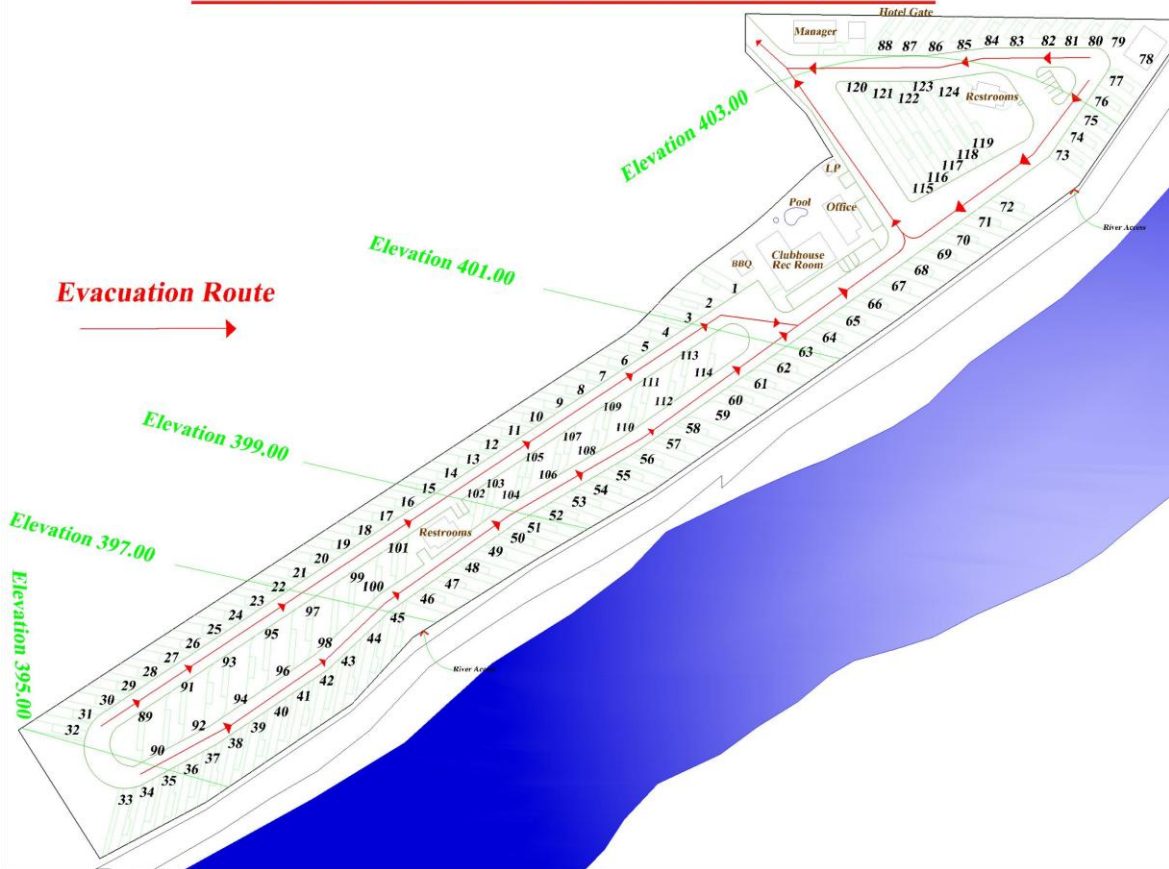

A complete Emergency Preparedness Plan for our guests is available in the office between the hours of 9:00 AM & 5:00PM or on the web at [riverrunrvpark.com/RivRunEmerPlan.pdf](http://riverrunrvpark.com/RivRunEmerPlan.pdf)

### In the event of an emergency dial 911

#### Other Contact Information

River Run RV Park Office: (661)377-3600

River Run RV Park Emergency Contact: (661)303-4409

Bakersfield Police Department(Non Emergency): (661)327-7111

Additional contact information available in the Emergency preparedness Plan

## Emergency Preparedness Plan

### Common Disasters & Procedures for Responding to Each



**1. Earthquake** - Prior to any earthquake, each guest/resident should preplan and practice steps they will take in the event of an earthquake.

If you are indoors:

- Take cover under any sturdy piece of furniture.
- Stay away from windows or ceiling objects such as lighting fixtures.
- **Do not light matches** or candles.
- **Do not turn on electrical** equipment of any kind.
- Use only **battery operated** flash lights and radios.
- If emergency assistance is needed call 911.

If you are outdoors:

- Find an open area and remain there until the earthquake stops.
- Stay away from power poles and electrical lines, tall buildings, bridges, brick or block walls, underpasses and trees.
- Listen to a self contained (battery operated) radio for emergency instructions.
- Confine and secure all pets so they will not hamper emergency service employees in the performance of their duties.
- After shocks may occur, so be prepared.
- If emergency assistance is needed call 911.

Park Staff will be available across from the office with any information that is available, to answer any questions or to provide assistance as needed.

**2. Fire** - There are steps you can take to minimize the dangers associated with fires and improve your chances of survival should a fire erupt in or around your RV, campsite or park.

Prevention and Safety Tips:

- Be sure you have properly operating smoke detectors and fire extinguishers. If one or more of your smoke detectors are battery operated, replace the batteries annually or more often if necessary. An easy to remember schedule is to change your batteries to coincide with daylight savings time.
- Make sure everyone knows how to use the emergency exits in your RV. Practice using them with the whole family.



## Emergency Preparedness Plan

- Be sure your heating and electrical systems are properly maintained and in good working order. Carefully follow the instructions on all appliances and heating units, taking special care not to overload your electrical system.
- Keep matches, lighters, and candles away from small children. Children tend to be curious about fire and tend to hide when frightened.
- Make an itemized list of your personal property, including furniture, clothing, appliances, and other valuables. If available, make a video tape of your possessions. Keep the list and/or tape up-to-date and store them along with the other important documents.

### In Case of Fire in your RV:

- Immediately assess the problem to assist you in exiting away from the fire source
- Know how to use a fire extinguisher
- Get everyone out of the RV **immediately**
- **Without risk to any person**, get pets out of the RV.
- Call 9-1-1 or the Fire Department, then call the park office (661)377-3600 or (661)303-4409 (from a neighbor's phone or a cell phone.)

*and:*

1. Give: your name, telephone number you are calling from, park address (3715 Burr St), space number where the fire is and any helpful directions.
2. Describe the type/nature of the fire (gas, wood, chemical, electrical).
3. State that the fire is in an RV and report any known injuries. Stay on the line and allow the person you contacted to end the call.
4. If and only if safe, turn off the propane and disconnect the electricity.
5. Tell all residents or guests near the fire source to stand ready with water hoses to wet down their structures or adjacent building(s) in case of traveling sparks.
6. Make sure all guests have left the affected structure and **immediately** let the fire department personnel know if any disabled person(s) or anyone not accounted for and may still be in the structure.
7. **Never go back into a burning structure.**
8. If smoky conditions are present, remember that smoke rises and stay as close to the floor as possible. Before exiting a door, feel the bottom of the door with the palm of your hand. If it is **hot**, find another way out. **Never open a door that is hot to the touch.**
9. Should your clothing catch fire: **first drop...then roll. Never run.** If a rug or blanket is handy, roll yourself up in it until the fire is out.

### **3.Flood** – Items you should know in the event of a flood.

- Know the elevation of your location in relation to nearby streams, rivers, and lakes.
- Have several escape routes planned.

## Emergency Preparedness Plan

- The National Weather Service continuously broadcasts updated weather conditions, warnings and forecasts on National Oceanic Atmospheric Administration (NOAA) weather radios. A NOAA radio may be purchased at radio or electronic stores. Local broadcast stations transmit Emergency Alert System messages which may be heard on standard radios.
- When rising water threatens, move your RV to higher ground.
- If one escape route is not passable do not waste any time - try another route or back track to higher ground. Use travel routes specified by local officials. **Never** drive through flooded roadways. **Do not** bypass or go around barricades.
- Wear life preservers if possible. Wear appropriate clothing and **sturdy shoes**.
- Avoid any contact with flood water. Flood water may be contaminated and pose health problems. If cuts or wounds come in contact with flood waters, clean the wound as thoroughly as possible.
- Take your Emergency Disaster Supplies Kit with you.
- When you reach a safe place, call your pre-determined family contact person.

After a flood:

- Return back to your RV site **only** after authorities say the danger of more flooding is over.
- If fresh food has come in contact with flood waters, **throw it out**.
- Do not reconnect to water, sewer or electric until park management has authorized you to do so.



## Provisions for residents who may need assistance



If a guest/resident expects to need assistance during an emergency please inform the office. If a guest/resident of the park needs assistance during an emergency call the office at (661)377-3600 or (661)303-4409. Park staff will provide assistance as we are able but *it should be understood that park management is not responsible for physically evacuating residents from their homes or providing any materials or services during an emergency.*



## **Emergency Preparedness Plan**

### **Individual Emergency Plan for Residents & Guests of RV Parks & Campgrounds**

#### **1. Introduction**

In the unlikely event of a natural or man-made disaster, we want our guests to have the utmost safety procedures in place. If you are a transient guest in our park, more than likely you have all the recommend items for a personal emergency plan. Make sure you are familiar with our park's evacuation routes and procedures and discuss them with your family or other's in your party.

The next time disaster strikes, you may not have much time to act. Prepare now for a sudden emergency. Knowing what to do in an emergency is your best protection and your responsibility. Learn how to protect yourself and your family by planning ahead.

To obtain more information, you may want to contact your local emergency management agency or civil defense office and the local American Red Cross chapter be prepared to take notes.

A checklist follows to develop your own personal emergency plan.

- Find out which disasters are most likely to occur in the areas you are visiting.
- Know how to prepare for each disaster and how you would be warned of an emergency.
- Learn about the community's warning signals: what they sound like and what you should do when you hear them.
- Learn the park's main evacuation routes.
- If needed, ask about special assistance for elderly or disabled persons.
- Ask about animal care during and after an emergency. Animals may not be allowed inside emergency shelters due to health regulations.

#### **2. Checklist of Emergency Procedures**

Meet with your family and discuss why you need to prepare for disasters. Explain the dangers of fire, severe weather and earthquakes to children, elderly individuals, and persons needing special assistance. Plan to share responsibilities and work together as a team. The following may be used in creating your own emergency plan:

- Discuss what to do in an evacuation.
- Pick an alternative location to meet, in the event a family member cannot return to the campsite.
- Pick one out-of-state and one local friend or relative for family members to call if separated by disaster (it is often easier to call out-of-state than within the affected area).

## Emergency Preparedness Plan

- Instruct family members to turn on a battery powered radio for emergency information.
- Teach children how and when to call 9-1-1 and a long distance contact person.
- Keep family records in a water and fire-proof container.
- If your RV can not be evacuated, make sure to turn the propane tanks off. Disconnect the RV from power, water and cable/electric. If you are staying in a Recreation Park Trailer, locate the main electric fuse box, water service main, and natural gas main shut off valve. Learn how and when to turn these utilities off.
- Take a basic first aid and CPR class.
- Prepare a disaster supply kit

### 3.If Disaster Strikes:

- Remain calm and patient. Put your plan into action.
- Check for injuries; give first aid and get help for seriously injured.
- Listen to your battery powered radio for news and instructions.
- Evacuate if advised to do so. Wear appropriate clothing and sturdy shoes.
- Check for damage to your RV - use a flashlight only. **Do not light matches or turn on electrical switches**, if you suspect damage.
- Check for fires, fire hazards and other household hazards.
- If you are remaining in your RV, sniff for gas leaks, starting at the hot water heater. If you smell gas or suspect a leak, turn off the propane tanks, open windows, and get everyone outside quickly.
- Shut off any other damaged utilities.
- Clean up spilled medicines, bleaches, and any other flammable liquids immediately.



### 4.Remember to:

- Confine or secure your pets.
- Call your family contact - **do not use the telephone again unless it is a life-threatening emergency.**
- Check on your neighbors, especially elderly or disabled persons.
- Make sure you have an adequate water supply in case service is shut off.
- Stay away from downed power lines.



## Emergency Preparedness Plan

### 5. First Aid Procedures

Information on first aid can be found in your local phone book or by contacting the American Red Cross. Utilize known persons who are medically trained (such as Doctors, Nurses, or people medically trained in CPR and first aid) to assist in administering first aid to those injured.

If the injured individual(s) are in imminent danger they should carefully be moved to a safe location to administer first aid. In the case where injuries are severe and movement could cause further injuries, **do not move** the injured. Make the injured person(s) as comfortable as possible and wait for emergency personnel.

Before emergencies, prepare a first aid kit. Have the kit in an easy to locate place. Make sure all family members know the location of the kit.

### 6. Be Prepared!

Government and Relief Agencies estimate that after a major disaster, it could take up to three days for relief workers to reach some areas. In such cases, a 72 hour disaster supply kit could mean the difference between life and death.

In other emergencies, a 72 hour disaster supply kit means the difference between having a miserable experience or one that's like a pleasant family camp out.

In the event of an evacuation, you will need to have items in an easy-to-carry container like a backpack or duffle bag.

### 7. Family Disaster Supplies Kit

You should inspect your supplies at least twice a year or before each trip. Rotate food and water every six months. Check children's clothing for proper fit. Adjust clothing for winter or summer needs. Check expiration dates on batteries, light sticks, warm packs, food and water. Keep a light source stored in the top of your kit for easy access in the dark.

More than likely most of the recommended supplies are already included in your RV or camp supplies. If not, you might want to consider adding these items to your packing list.

#### Sample First Aid Kit

Sterile adhesive bandages in assorted sizes  
2 & 4-inch sterile gauze pads (4-6 each)  
Hypoallergenic adhesive tape  
Triangle bandages (3)  
2 & 3-inch sterile roller bandages (3 rolls each)  
Scissors  
Tweezers  
Needle  
Moistened towelettes  
Antiseptic  
Thermometer  
Tongue blades (2)  
Tube of petroleum jelly or other lubricant  
Assorted sizes of safety pins  
Cleansing agent/soap  
Burn gel & dressings  
Latex gloves (2 pairs)  
Sunscreen  
Aspirin  
Syrup of Ipecac  
Activated charcoal (use only if advised by the Poison Control Center)

### 8. Family Disaster Supplies Kit Checklist:

- 3-5 gallons of water (one gallon/person/day) & method of water purification
- Food: ready-to-eat canned meats, fruits, and vegetables; canned juices, milk, soup; high energy foods - peanut butter, jelly, crackers, granola bars, trail mix; specialty foods for infants, elderly persons or persons on special diets; comfort/stress foods - cookies, hard candy, sweetened cereals, lollipops, instant coffee, tea bags; vitamins
- Matches in a waterproof container and second method of starting a fire
- Tent/shelter
- Wool-blend blankets or sleeping bags (1 per person)
- Emergency reflective blanket
- Lightweight stove and fuel
- Hand and body warm packs
- Rain poncho
- Flashlight, batteries, and extra batteries
- Candles and/or Light sticks
- Pocket/utility knife and Tools (pliers, hammer, screw drivers, shovel, hatchet or axe,)
- Sewing kit
- 50-foot nylon rope
- First aid kit and supplies, insect repellent and sun block/sun glasses
- Radio, batteries, and extra batteries
- Whistle with neck cord
- Personal sanitation equipment
- Personal comfort kit (include soap, toothbrush, toothpaste, comb, tissue, razor, deodorant), and any other needed items
- Extra Clothing (include at least one complete change of clothing and footwear per person per day) extra socks, underwear, hat, gloves, and sturdy shoes
- Mess kits, paper cups, plates and plastic utensils, non-electric can opener, foil
- Cash (at least \$20) or traveler's checks, change for phone calls
- Fire extinguisher: small canister, ABC type
- Portable toilet
- Tape
- Compass
- Signal flare
- Household chlorine bleach
- Special or prescription medication, contact lenses, a spare set of glasses
- Baby items - formula, diapers, bottles, powdered milk, medications, and favorite security items





## Emergency Preparedness Plan

### Local Emergency Phone Numbers

Agency:	Phone Number:
Emergency	911
Park Office	(661)377-3600
Park Emergency Contact	(661)303-4409
Bakersfield Police Department (non emergency)	(661)327-7111
State-Federal Flood Operations Center	(800) 952-5530
Cal Fire	(916) 653-5123
Department of Water Resources Flood Management	(916) 574-0601
National Weather Service (NWS)	(916) 979-3051
<b>Department of Housing and Community Development (HCD)</b> <i>Division of Codes and Standards, Manufactured Housing Section</i> <i>HCD Northern Area Office</i> 8911 Folsom Blvd., Sacramento 95826	(916) 255-2501
<i>HCD Southern Area Office</i> 3737 Main Street, Suite 400, Riverside 92501	(909) 782-4420
<b>California Emergency Management Agency (CalEMA)</b>	<b>916-845-8510</b>

**CalEMA Mutual Aid Region V – 550-445-5806**  
*Encompasses the counties of: Merced, Mariposa, Madera, Fresno, Kings, Tulare, Kern*



### Local Emergency Broadcast Station Frequencies

FM		
	107.9	KUZZ
	95.3	KELLY
AM		
	1560	KNZR



## Emergency Preparedness Plan

**FEMA Regulations** - Title 44, Sec. 60.3,(c)14 and (e)9 states: (Communities must) Require that recreational vehicles placed on sites within Zones A1-30, AH, and AE on the community's FIRM either

- (i) Be on the site for fewer than 180 consecutive days
- (ii) Be fully licensed and ready for highway use

A recreational vehicle is ready for highway use if it is on its wheels or jacking system, is attached to the site only by quick disconnect type utilities and security devices, and has no permanently attached additions.

**California Regulations** - Title 23, Section 114 outlines the existing general evacuation procedures for recreational vehicle parks in a floodway.

(c) Recreational vehicle parks are subject to the following requirements:

(1) New and existing recreational vehicle parks are allowed within an adopted plan of flood control if a permit is obtained from the board, a current implementable evacuation plan is on file with the board, and the following requirements are enforced:

- (A) The locations of all recreational vehicle pads and appurtenances are shown on the evacuation plan.
- (B) All recreational vehicles have axles, wheels, and any required tow hitch installed, and are in readily movable condition at all times.
- (C) At the initiation of an evacuation, all recreational vehicles are removed from the floodway within the time period specified in the evacuation plan.
- (D) At the initiation of the evacuation, all floatable and portable structures are removed from the floodway within the time period specified in the evacuation plan.
- (E) The locations of emergency storage areas outside the floodway for recreational vehicles, and portable and floatable structures are shown on the evacuation plan.
- (F) The location of the river staff gauge and the gauge height that will initiate an evacuation are shown on the evacuation plan.
- (G) Permittees or managers of recreational vehicle parks accept sole responsibility for initiating an evacuation.
- (H) Any related structures, such as laundry rooms or storage buildings, are securely anchored and are not utilized for human habitation.
- (I) If significant flood damage occurs to any of the recreational vehicles or other park structures due to the failure of the evacuation plan or its execution, the park may not continue operating without the approval of the board.